

Male/Female Stud Adaptor, Long Form

DIN/ISO 228
Whitworth

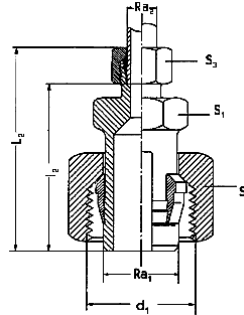

PN	G1	G2	i	S1	d3	l	t	weight %	article
630	G 1/8 A	G 1/4	8	19	14	31	17,0	3,9	RIG 1/8x1/4
	G 1/8 A	G 3/8	8	24	14	32	17,0	6,4	RIG 1/8x3/8
	G 1/4 A	G 1/8	12	19	18	28	12,0	3,8	RIG 1/4x1/8
	G 1/4 A	G 3/8	12	24	18	36	17,0	6,8	RIG 1/4x3/8
	G 1/4 A	G 1/2	12	30	18	40	20,0	8,7	RIG 1/4x1/2
400	G 1/4 A	G 3/4	12	36	18	43	22,0	17,5	RIG 1/4x3/4
630	G 3/8 A	G 1/4	12	22	22	36	17,0	7,0	RIG 3/8x1/4
	G 3/8 A	G 1/2	12	30	22	41	20,0	9,4	RIG 3/8x1/2
400	G 3/8 A	G 3/4	12	36	22	44	22,0	18,3	RIG 3/8x3/4
	G 1/2 A	G 3/8	14	27	26	36	17,0	9,2	RIG 1/2x3/8
	G 1/2 A	G 3/4	14	36	26	46	22,0	18,6	RIG 1/2x3/4
	G 1/2 A	G 1	14	41	26	49	24,5	22,0	RIG 1/2x 1
250	G 1/2 A	G 1 1/4	14	55	26	53	26,5	48,7	RIG 1/2x1 1/4
400	G 3/4 A	G 1/2	16	32	32	41	20,0	14,4	RIG 3/4x1/2
	G 3/4 A	G 1	16	41	32	51	24,5	24,0	RIG 3/4x 1
250	G 3/4 A	G 1 1/4	16	55	32	55	26,5	48,1	RIG 3/4x1 1/4
	G 3/4 A	G 1 1/2	16	60	32	57	28,5	56,0	RIG 3/4x1 1/2
400	G 1 A	G 3/4	18	41	39	47	22,0	28,0	RIG 1 x3/4
250	G 1 A	G 1 1/4	18	55	39	57	26,5	51,3	RIG 1 x1 1/4
	G 1 A	G 1 1/2	18	60	39	59	28,5	58,6	RIG 1 x1 1/2
	G 1 1/4 A	G 1	20	50	49	52	24,5	45,8	RIG 1 1/4x 1
	G 1 1/4 A	G 1 1/2	20	60	49	60	28,5	60,2	RIG 1 1/4x1 1/2
	G 1 1/2 A	G 1 1/4	22	55	55	58	26,5	54,4	RIG 1 1/2x1 1/4

